

QUICK START GUIDE

FSC750/FSS850



FSC750 720P

FSC850 1080P

faleemi

Smart · Reliable · Secure

Faleemi Technologies Ltd



www.faleemi.com



support@faleemi.com



support@faleemi.com



www.facebook.com/faleemi

Apple, Apple Store, iPad, iPhone, MAC (Text, Logo, Picture) are trademarks of Apple, Inc.
Android, Google Play (Text, Logo, Picture) are trademarks of Google Inc.
Samsung (Text, Logo, Picture) is a registered trademark of Samsung Electronics Co., Ltd.
MicroSD text and logo are the trademark of SD-3C, LLC.
Wi-Fi is a registered trademark of the Wi-Fi Alliance.
All other products, names or companies are the brands or registered trademarks of their respective owners.



Technical specifications are subject to change without notice.
No responsibility is taken for errors in contents or printing.
© Faleemi Technologies Ltd or its affiliates. All rights reserved.

Version .01.2018



We at Faleemi are committed to do our part in protecting our environment. In this continuing effect, we have supplied the detailed manual and startup guide on our website <http://support.faleemi.com>.

www.faleemi.com



THANK YOU

Dear Customer,

Thanks for purchasing our products. If you encounter any problem while configuring your camera, or need additional information, please feel free to contact the Faleemi Support by **email/skype: support@faleemi.com**. Or visit the Faleemi website : **https://www.faleemi.com/faq**.

What's in the box ?

- Faleemi Wifi IP Camera FSC750(720P)/FSC850(1080P)
- Ceiling/Wall Mounting Bracket
- Mounting Screws & Plugs
- Power Adapter
- Quick Start Guide



Connections

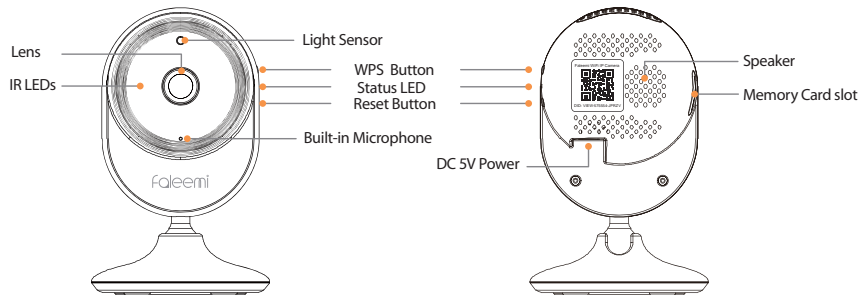

* Status LED Solid Light Blinking Slowly Blinking Quickly

Indicator Light Status	Device Status
Red light is blinking slowly	Power up and activating
Red and blue lights are blinking slowly	The device is ready to connect
Blue light is blinking quickly	The device is receiving the wifi signal or connecting to the wifi
Blue and red lights are solid and steady	The device is connected to the network
Red light is blinking quickly	The device is reset to restore to factory default
Blue light goes off	The device failed to connect to the network



Please download the Faleemi APP before doing the setup

Download the App (Android and iOS)

First, connect your mobile device to your WiFi and download the App "Faleemi" from the App Store or Google Play store, or scan below QR code to download it.



Now, please follow below instructions to get your camera set up.

Setup Method 1 WPS/QSS Connection Method



Please check if your wifi router has a "WPS/QSS" button or a WPS icon (see below picture).

Usually it is on the top of your router, or 2 sides, back or bottom. If you find there is a WPS/QSS button, please follow below steps to do the setup. **If you don't find this button, please turn to page 7 to use your mobile phone to do the setup.**

WPS:

Wi-Fi Protected Setup (Wi-Fi Simple Config) is a network security standard to create a secure wireless home network. The standard emphasizes usability and security.

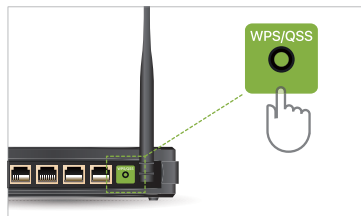

WPS Button

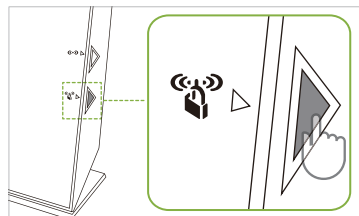

WPS Icon

1. Please move the camera to be close to your wifi router and plug it in.

TIPS:

Make sure your wifi name and password do not have the special characters "&" and "'".

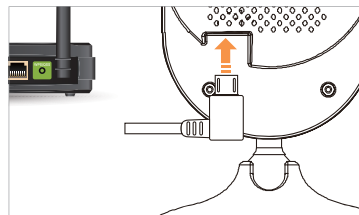

2. Please wait for about 1 minute until the camera is initialized. You will see both red and blue lights are flashing. Please press down the reset button for about 3 seconds and then let it go.

(Please don't push it down for a longer time, because if too long, it goes for Reset, not WPS.)

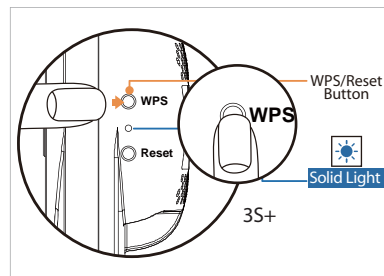

Because the reset button is very small, not easy to hold down, please make sure to push down the Reset button for about 3 seconds and then let it go.

And then you will see the blue light turns on, solid and steady (not blinking).

3. At this time, press the WPS button on your router once.

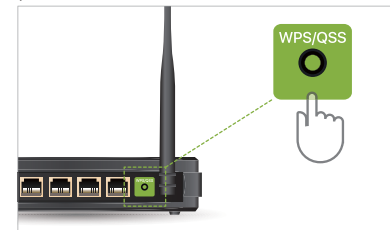

4. You will hear the sound "beep beep" in 5 seconds, that means the camera is connecting to your WiFi.

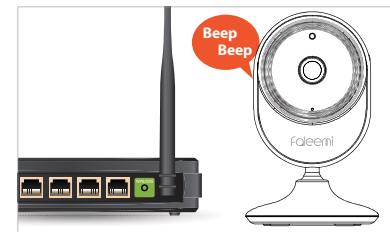

Wait for around 30 seconds, Please follow below steps to add the camera to your mobile phone.

Please make sure your phone is connected to your WiFi (the same WiFi what your camera connected to), Open the Faleemi App.

1. Click on **[Add Camera]**.

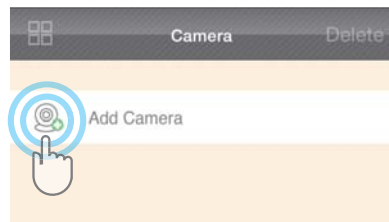

2. Click on **[Add the cameras which are already connected to your WiFi network]**



3. Click on **[LAN Search]**.

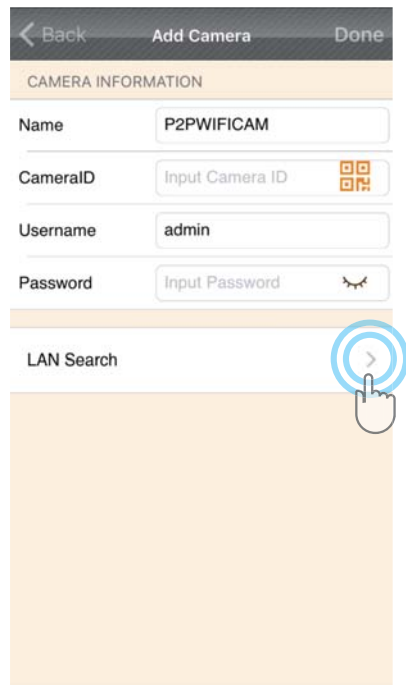

4. Click on the camera searched.

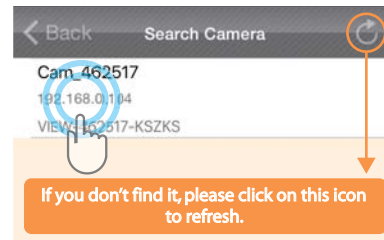

5. Give your camera a name, and Default Password(**123456**), click on **[Done]**

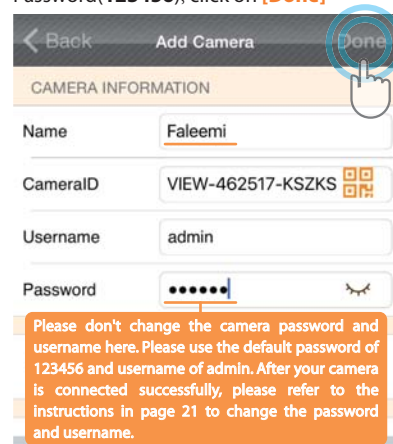

6. It will go back to below interface automatically. It will show online. And just **click on the image** to start to view & control.

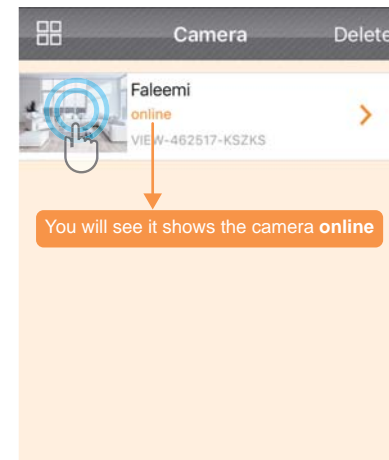

Congratulations!

Your camera is connected now



To ensure the security of your camera, you are suggested to change the default password. Please refer to the instruction in Page 21.

Setup Method 2 Mobile Phone Setup



Before configuring your camera, please read the points below.

1. To ensure the camera works stable, please make sure to put your camera close to your wifi router, if you could put them in the same room, that will be better.
2. Make sure your wifi router is connected to the Internet.
3. Make sure your phone is connected to your **2.4GHz WiFi (not cellular data and 5GHz WiFi)** before doing the setup.
4. Make sure your wifi name and password do not have the special characters "&" and "'".
5. If you don't see the **blue light** , please do a **"Factory Reset"**. This process is outlined on **Page 22** of this manual. ("**How to restore to factory default**").

Camera Configuration

1. Please **put your camera close to your wifi router** and plug it in, you will hear "beep" after 40 seconds. The camera is initializing by rotating from left to right and up to down and stop in center finally (25s). And then you will see the red and blue lights are blinking slowly  (around 80s after the camera powered up).



5 mins
NOTE

Only when it blinks red & blue slowly  you are able to set up the camera. It lasts **only 5 mins** after the camera is powered up. If you don't do the configuration during this time period, please unplug the camera and plug it in again to get another 5 mins setting time.



Note, when the camera is startup, it will sound one "beep"

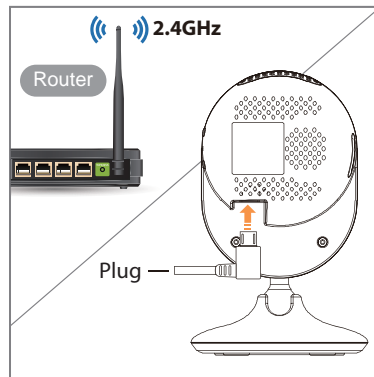

2. Open the Faleemi App, click on **[Add Camera]**.

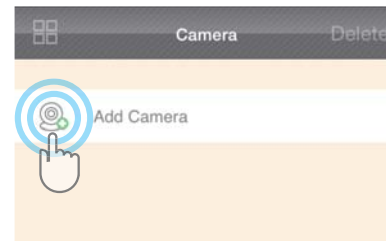

3. Click on **[Add cameras via WiFi configuration guide]**.

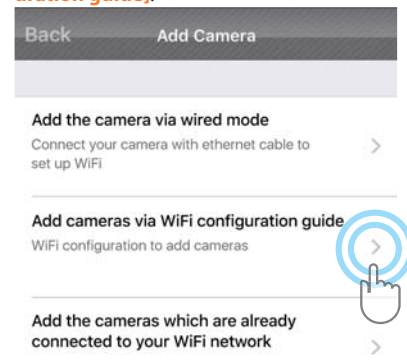

4. Click on **[The blue light is flashing slowly]**.

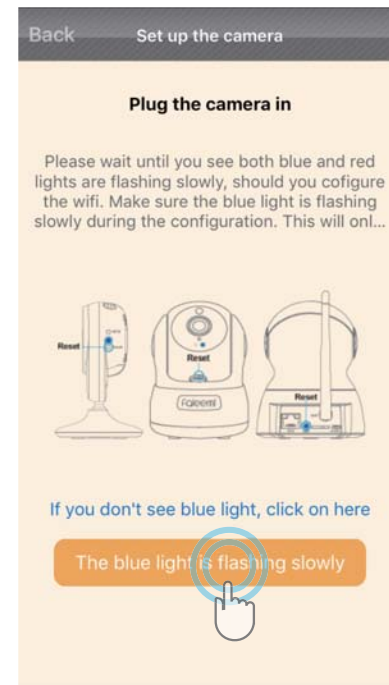

5. Please scan the QR Code at the bottom of the camera

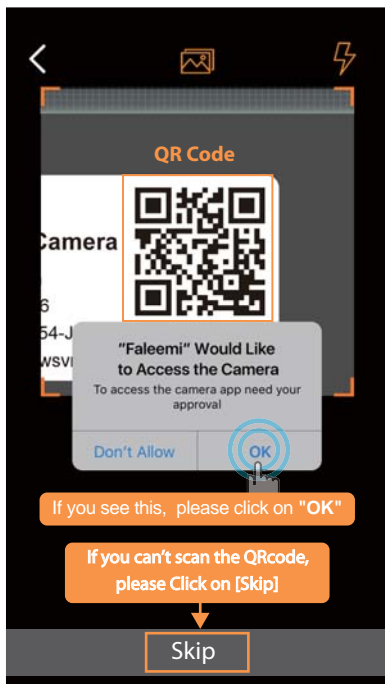

6.Type in the name you have selected for your camera and click on **[Next]**.

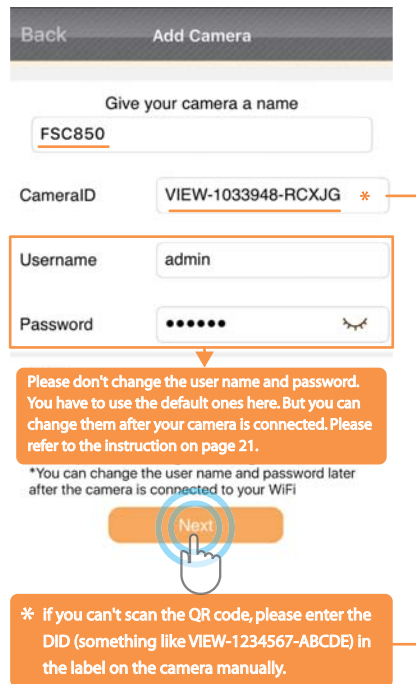

7. Input your WiFi password and click on **[Connect to WiFi]**.

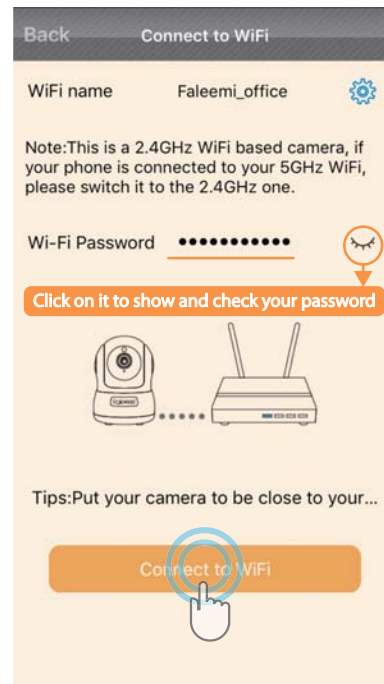

8. Click on **[Next]**.

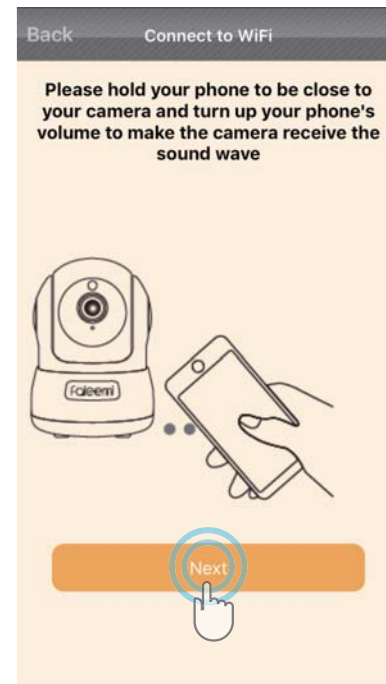

9. Click on **[Start]**

Note: Please click on "Start" button. Your phone will make a loud sound to transmit the data to the camera. When the camera receives the wifi signal, it will sound with 2 beeps.



10. After the wifi is connected, it will go back to below interface automatically. It will show online. And just **click on the image** to view live video.

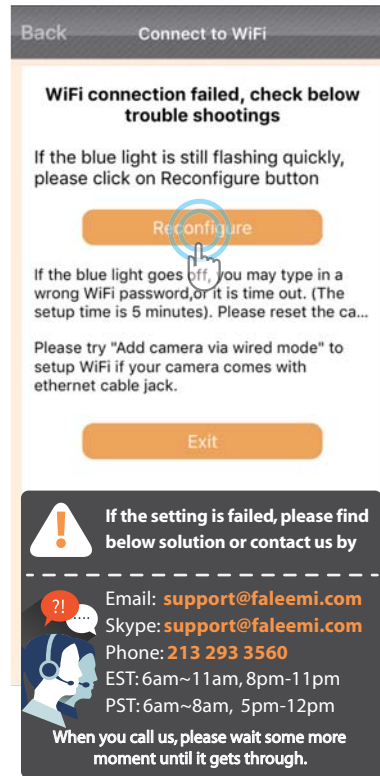
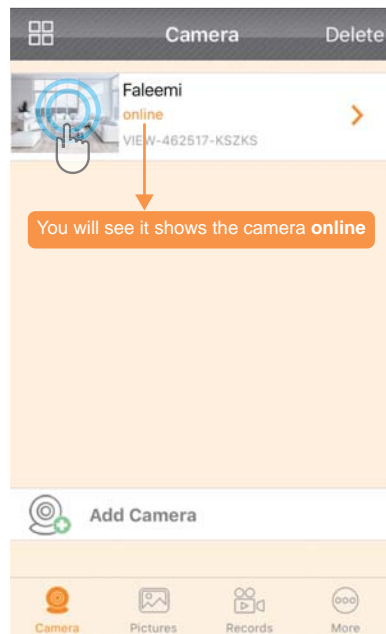

If the setting is failed, please find below solution.

1. Please check if your WiFi password is correct and re-configure it again.

2. If the wifi password is correct, it always lets you try again. **This is because for some routers, you may not hear double beep after the WiFi connection is succeeded.**

(If the blue LED is blinking rapidly (See table bottom at page 2), it indicates that the camera setup has taken longer than 4 mins.

Please unplug the camera and plug it in again, wait around **90 seconds**, after it is initialized, you will see both red and blue lights are solid.

((This means the camera is connected to your wifi) Then please go back to home page and follow the steps in **Page 5** to add the camera to your Faleemi App and **no need to set up wifi again.**

3. If you still can't add it to your Faleemi APP, please follow the guide in **Page 22 [5. How to restore to factory default?]** to **reset your camera** and follow the steps since **Page 7** to do the settings again.

Live Video Interface



Turn on the Microphone; you will see a pop-up button "Hold Talk", press down this button to talk to the people at the camera side.

- | | | |
|------------------------------|-------------------------|-----------------------------------|
| ⬆️ Cruise Vertically (N/A) | 📷 Snapshot to phone | 🔄 Restore to default |
| ↔️ Cruise Horizontally (N/A) | 📹 Record video to phone | 720P 480P/720P/1080P>(*FSC850) |
| ☰ Menu | 🔊 Audio on/off | 📏 Contract |
| ⬅️ Flip | 🎤 Microphone on/off | 🔦 IR LED Off |
| ⬆️ Mirror | Ⓛ Contrast | ☀️ Auto |
| ✖️ Exit | ☀️ Brightness | 📞 Preset Set or Call Preset (N/A) |

Pan & Tilt Control

Please move the camera to adjust the angle.

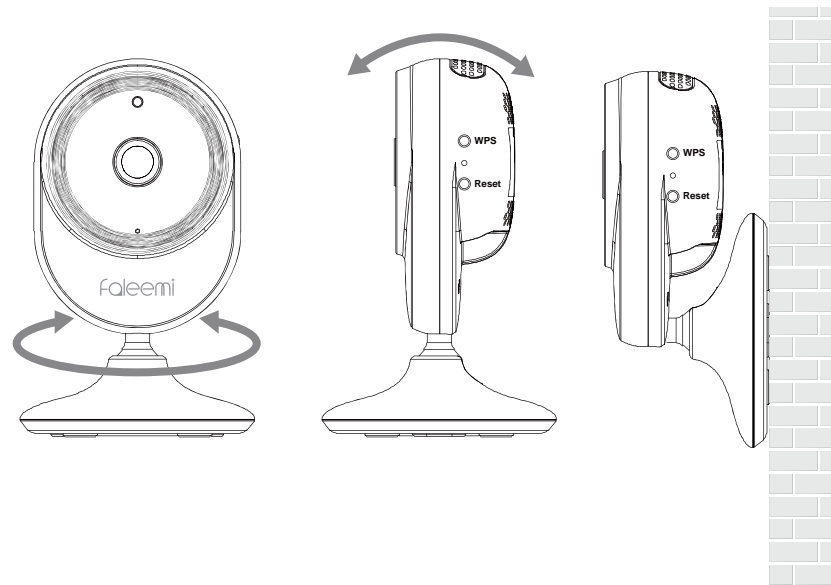

How to connect the camera to the second Phone?

After you use one phone to get your camera connected to your WiFi and you can view the live video from your first phone.

If you would like to add your camera to the second phone, **please ensure your second phone connects to your WiFi (the same WiFi your camera connected to)**.

1. Download the Faleemi App to your second phone.
2. Open the Faleemi App,
Click on **[Add Camera]**.

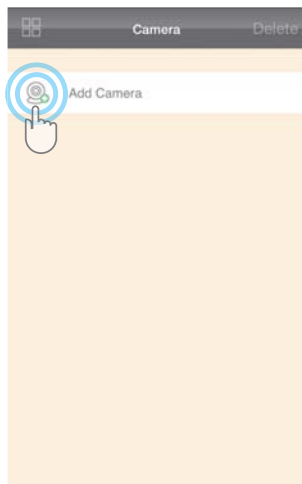

3. Click on **[Add the cameras which are already connected to your Wifi network]**

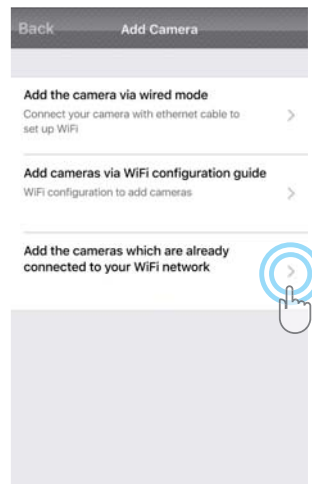

4. Click on **[LAN Search]**.

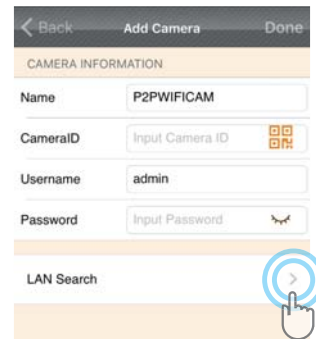

5. Click on the camera searched.

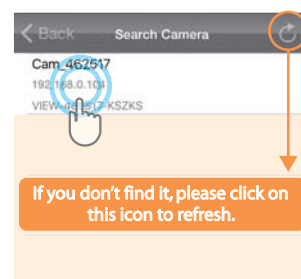

6. Give your camera a name, and input your Password, click on **[Done]** go back to home to start to view & control.

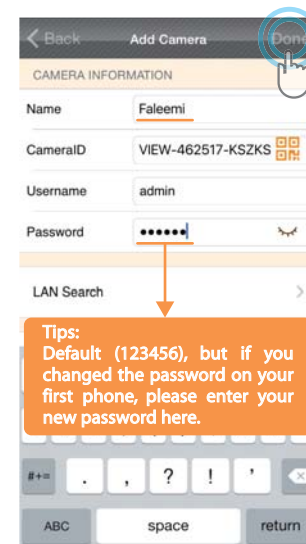

Advanced Settings

Please follow below steps to go to Advanced Settings to do more settings.

1. Click on the icon [>].
2. Click on [Advanced Settings].
3. Do advanced settings here.

Tips:
If you change your password, please remember to update the new password to your other phone and click on "Done"

How to set it to record constantly to the memory card?

* Please format your memory card before using.

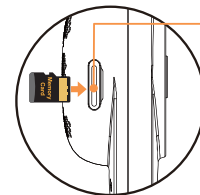

Meromy Card Slot

Please insert the Micro SD card as what shows at left.
Suggest to use MicroSDHC* Class10 UHS-1 Memory Card.

(* MicroSD, MicroSDHC text and logo are the trademark of SD-3C, LLC)

1. Click on [Advanced Settings].
2. Click on [Memory Card Setting].
3. Enable [Memory Card Recording]
4. Set [Record Time] (15 mins Max)
5. Click on [Done].

Tips: Max 15 Minutes

Tips:
If you just want to record alarm video to the memory card, please disable this button.

How to record alarm video to the memory card?

1. Click on the icon [>].
2. Click on [Alarm Setting]
3. Enable [Motion Detect Armed]
4. Enable [Save Video on the memory card]
5. Click on [Done]

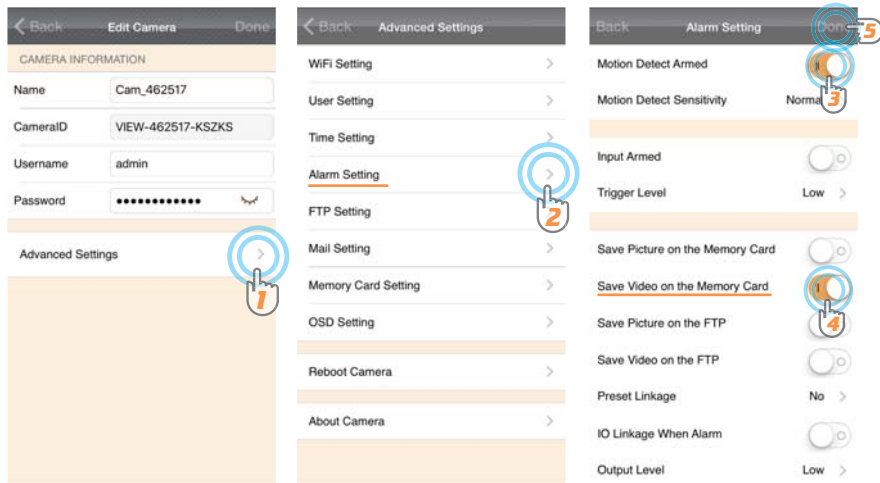

How to view the recorded video on memory card?

1. Click on [Records],
2. Click on [Remote].
3. Click on [All], select recording
4. Select Date
5. Click on [Done]
6. Click the file to play the recorded video

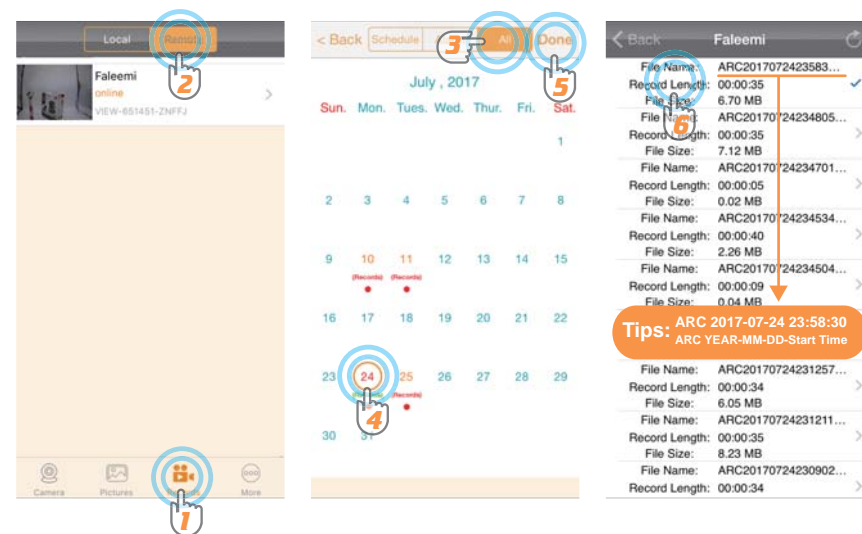

Trouble Shooting Frequently Asked Questions

1. How do I change my camera password?



To ensure the security of your camera, you are suggested to change the default password.

Please follow below steps to do it.

Click on the icon [>] at the right of the camera and select [Advanced Settings] and next [User Setting]. Enter your new password and click on [Done] on the top right. Note that once the password is changed here, it will take effect immediately.

1. Click on the [User Setting].

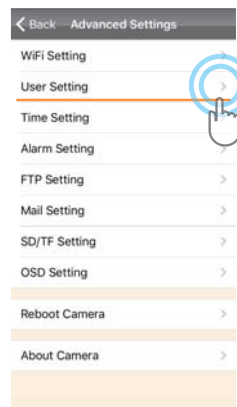

2. Select [admin], Click on [>].



3. Enter your new password, Click on [Done].

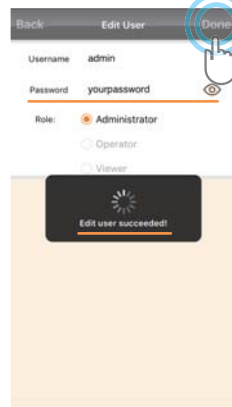

Record your new password here: _____

2.If you have several cameras, please follow below steps to use multi-view function.

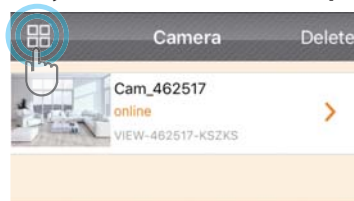

3. How do I change my video stream resolution?

Click on the icon 1080P to change the resolution.

4. I mounted my camera upside down, how do I flip my camera's video stream?

Click on [↔] [↕] to flip and mirror your camera.

5. How to restore to factory default?

Push down the "Reset" button for around 10-15 seconds until the red light changes from blinking slowly to very quickly and then let the Reset button go. If the reset is done successfully, you will hear beep. The camera will reboot automatically.

6. How to set email alert?

Please visit http://support.faleemi.com/FSC850/Email_alert.pdf
If there is no the guide for your email server, please email us support@faleemi.com.

Scan the QR Code to view

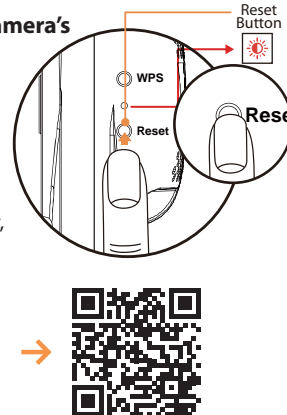

7. How to link your camera to your PC/Mac by Faleemi Plus

Windows: Please visit <https://youtu.be/sEuauwrchbs>

Mac: Please visit <https://youtu.be/pljGg0l86N8>